

- > Port size: G1/8 ... G1/2
- > Permit free flow of air in one direction only
- > Simple, reliable design
- > Light weight
- > Silicone free
- > Low cracking pressure



Technical features

Medium:
Compressed air, filtered, lubricated and non-lubricated

Operation:
Non-return valve

Operating pressure:
0,1 ... 10 bar (1,4 ... 145 psi)

Cracking pressure:
0,05 bar (0,7 psi)

Port size:
G1/8, G1/4, G3/8 & G1/2

Mounting:
Line mounted

Ambient/Media temperature:
-20 ... +80°C max. (-4 ... 176°F)

Air supply must be dry enough to avoid ice formation at temperatures below +2°C (+35°F).

Materials:
Body: aluminium
'O' ring: NBR (VMQ free)
Valve: POM
Spring: stainless steel

Technical data, standard models

Symbol	Port size	Flow factor C *1)	Cv	Kv *2)	Weight (kg)	Model
	G1/8	2,4	0,59	0,51	0,015	T55C1800
	G1/4	5,5	1,35	1,17	0,025	T55C2800
	G3/8	9,0	2,20	1,92	0,060	T55C3800
	G1/2	15,0	3,70	3,2	0,080	T55C4800

*1) Measured in dm³/(s.bar)
*2) Measured in m³/h

Options selector

T55★ ★ ★ 00

Thread	Substitute	Port size	Substitute
ISO G, parallel	C	1/8"	18
NPT	A	1/4"	28
		3/8"	38
		1/2"	48

Dimensions

B	C	D	E	Ø F	G	Ø H	Model
G1/8	42,5	7	7	13,5	4	15	T55C1800
G1/4	54	10	8	16,5	5	18,5	T55C2800
G3/8	63	13,5	9	23,5	7	24	T55C3800
G1/2	77	13,5	12	26,5	10	30	T55C4800

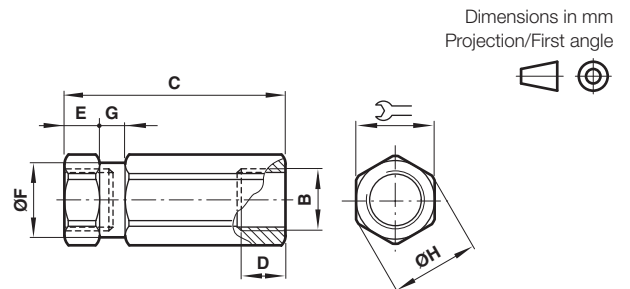

Warning

These products are intended for use in industrial compressed air systems only. Do not use these products where pressures and temperatures can exceed those listed under

»**Technical features/data**«.

Before using these products with fluids other than those specified, for non-industrial applications, life-support systems or other applications not within published specifications, consult IMI NORGREN.

Through misuse, age, or malfunction, components used in fluid power systems can fail in various modes.

The system designer is warned to consider the failure modes of all component parts used in fluid power systems and to provide adequate safeguards to prevent personal injury or damage to equipment in the event of such failure.

System designers must provide a warning to end users in the system instructional manual if protection against a failure mode cannot be adequately provided.

System designers and end users are cautioned to review specific warnings found in instruction sheets packed and shipped with these products.